



# METRO Orange Line Update

## Dakota County Regional Railroad Authority

### June 21, 2016

# Project Schedule & Major Milestones

	2015	2016				2017				2018				2019			
	Q4	Q1	Q2	Q3	Q4	Q1	Q2	Q3	Q4	Q1	Q2	Q3	Q4	Q1	Q2	Q3	Q4
Environmental Work	[Solid Blue]				[Solid Blue]												
PD & Engineering	[Solid Blue]				30%	60%	90%	[Solid Blue]									
FTA Coordination	[Solid Blue]			Pres. Budget	[Solid Blue]	Rating	Negotiate SSGA	Execute SSGA	[Solid Blue]								
Construction	[Solid Blue]							Construction Activities									
Revenue Service	[Solid Blue]																

### Orange Line Extension Schedule

- Regional solicitation application due July 15, selected Q1 2017
- Planning work begins 2016-2017
- Project Development and Engineering 2018-2019
- Construction 2020-2021

# General Project Updates

## Funding

- Lake Street Station TIGER grant request: \$12.5M
- 2016 Legislative ask: \$12.1M (completes state share)
- Requesting CTIB full project funding commitment (\$45.2M) in August 2016
- Apply to Small Starts by Sept. 2, 2016 for inclusion in President's budget

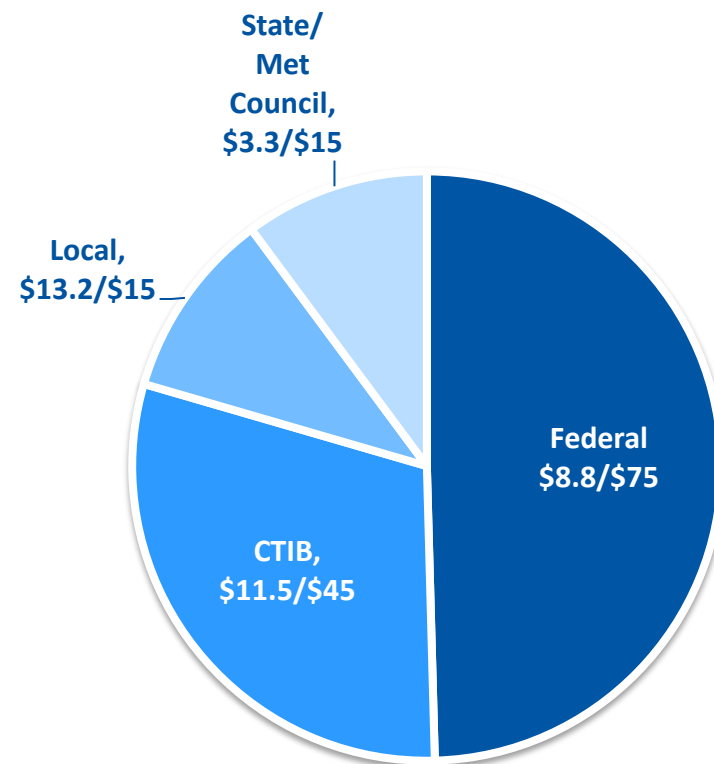

**Anticipated Capital Sources,  
in Millions (secured/total, \$MM)**

## Environmental

- Minneapolis Municipal Consent for 35W Lake Transit/Access Project in May
- Orange Line environmental document available for public review

# Station Design: Influences from Existing System



# Station Components



Heaters



Materials

Real-time signage



Pylon



Ticket vending machines



LED Lighting



# Station Design Concepts

Back of platform is adjacent to sidewalk or development

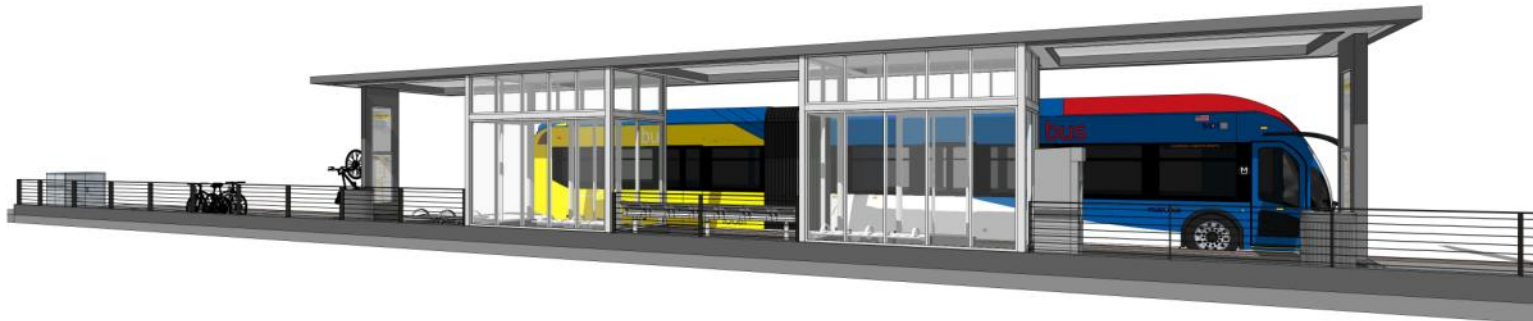
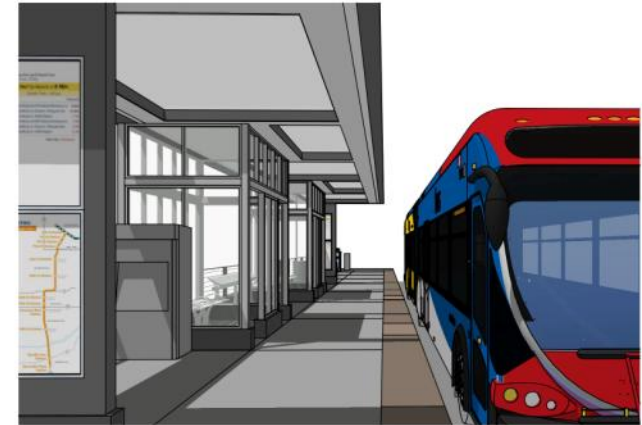

# Station Design Concepts

Back of platform is adjacent to noise wall or highway

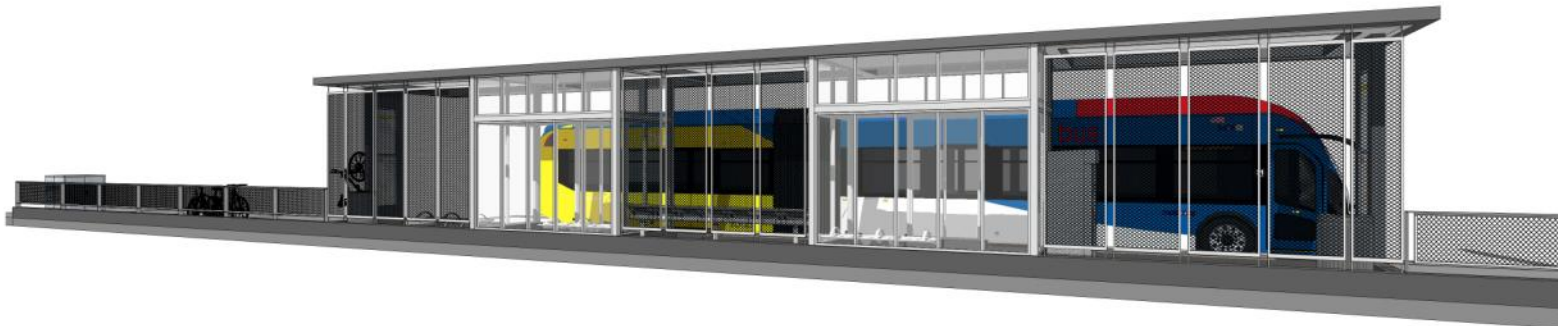
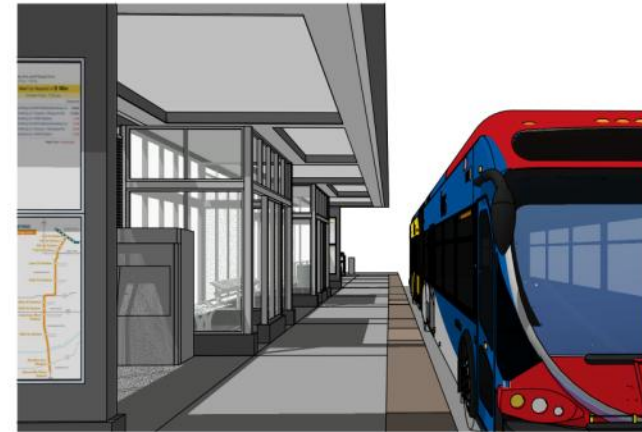
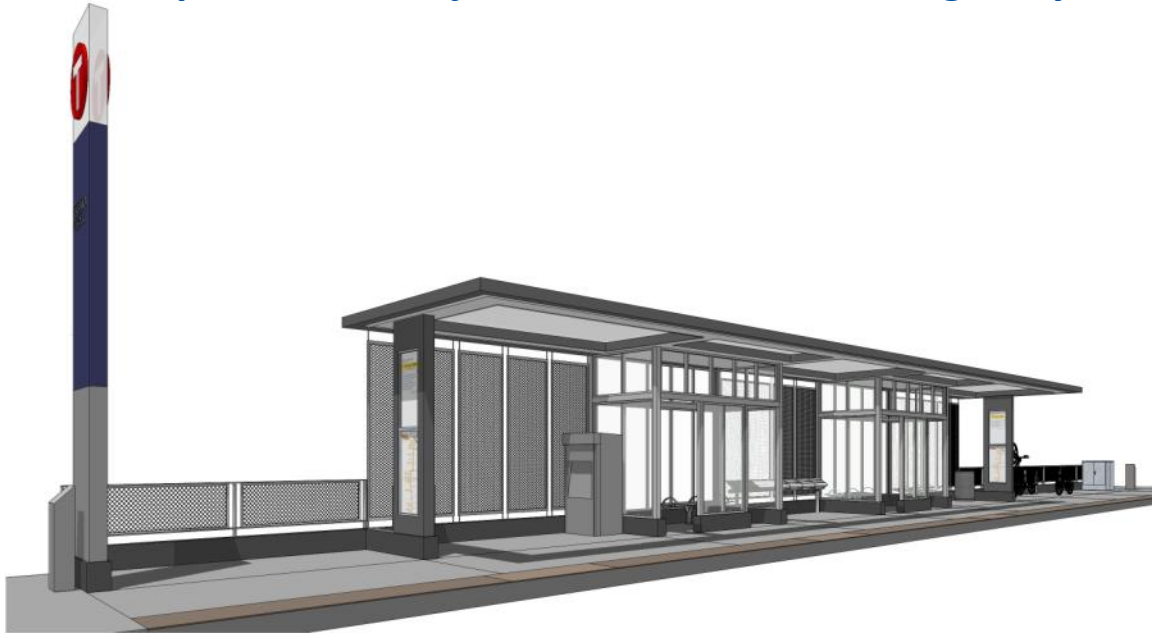

# Station Design Considerations

## Environment

- Landscaping, approach to public art, pedestrian-level and station lighting, safety & security

## Station amenities

- Bike parking
- Location of fare collection, signage, and real-time information
- Location, height, and function of pylon

## Connections & transfers

- Location & facilities at connecting bus stops, off-platform wayfinding
- Pedestrian paths & flow, connection to trails

## Sightlines & visibility

- To and from station, approaching bus, and real time signage



# Nicollet Avenue Station

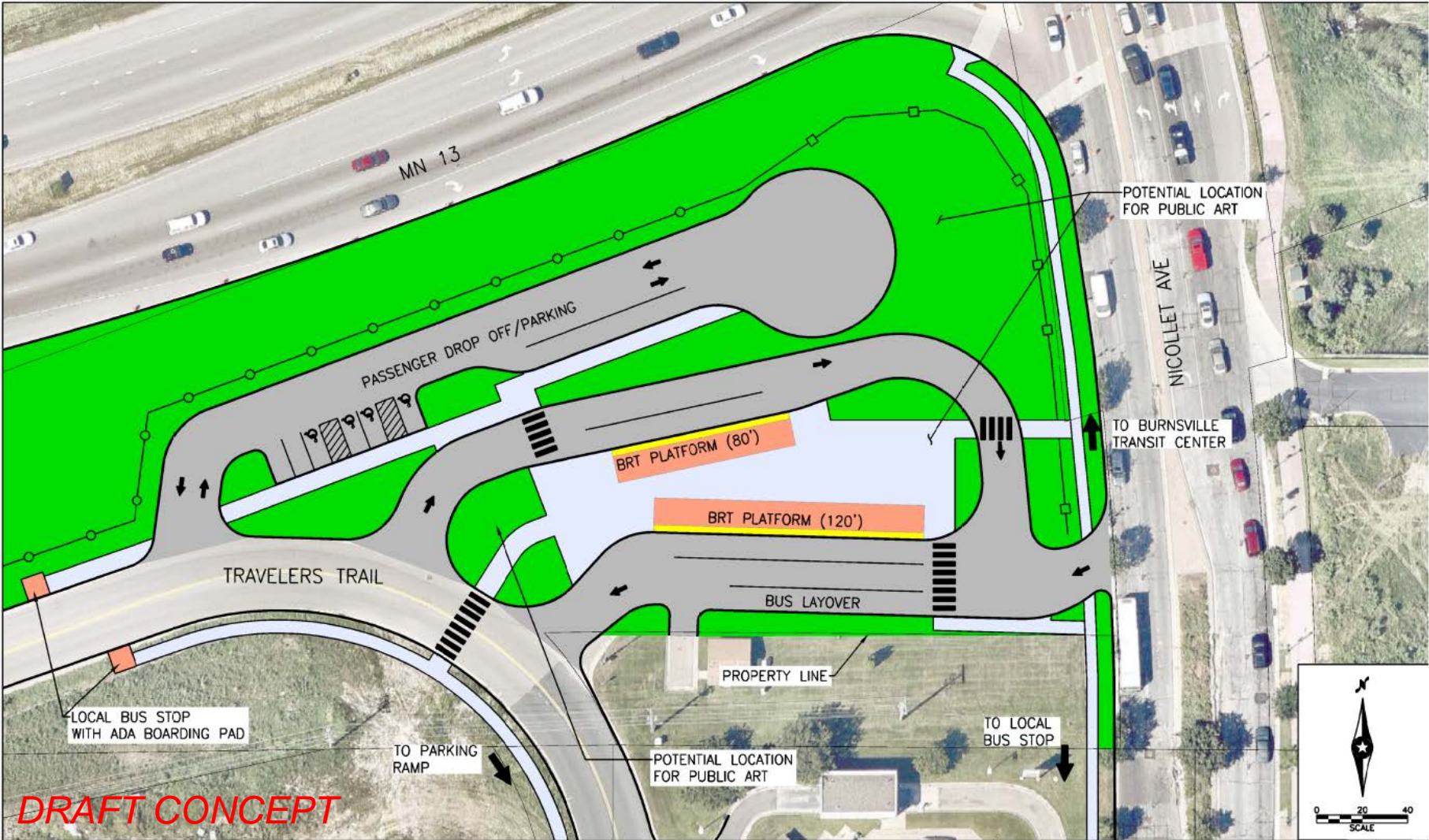



# Burnsville Parkway Station

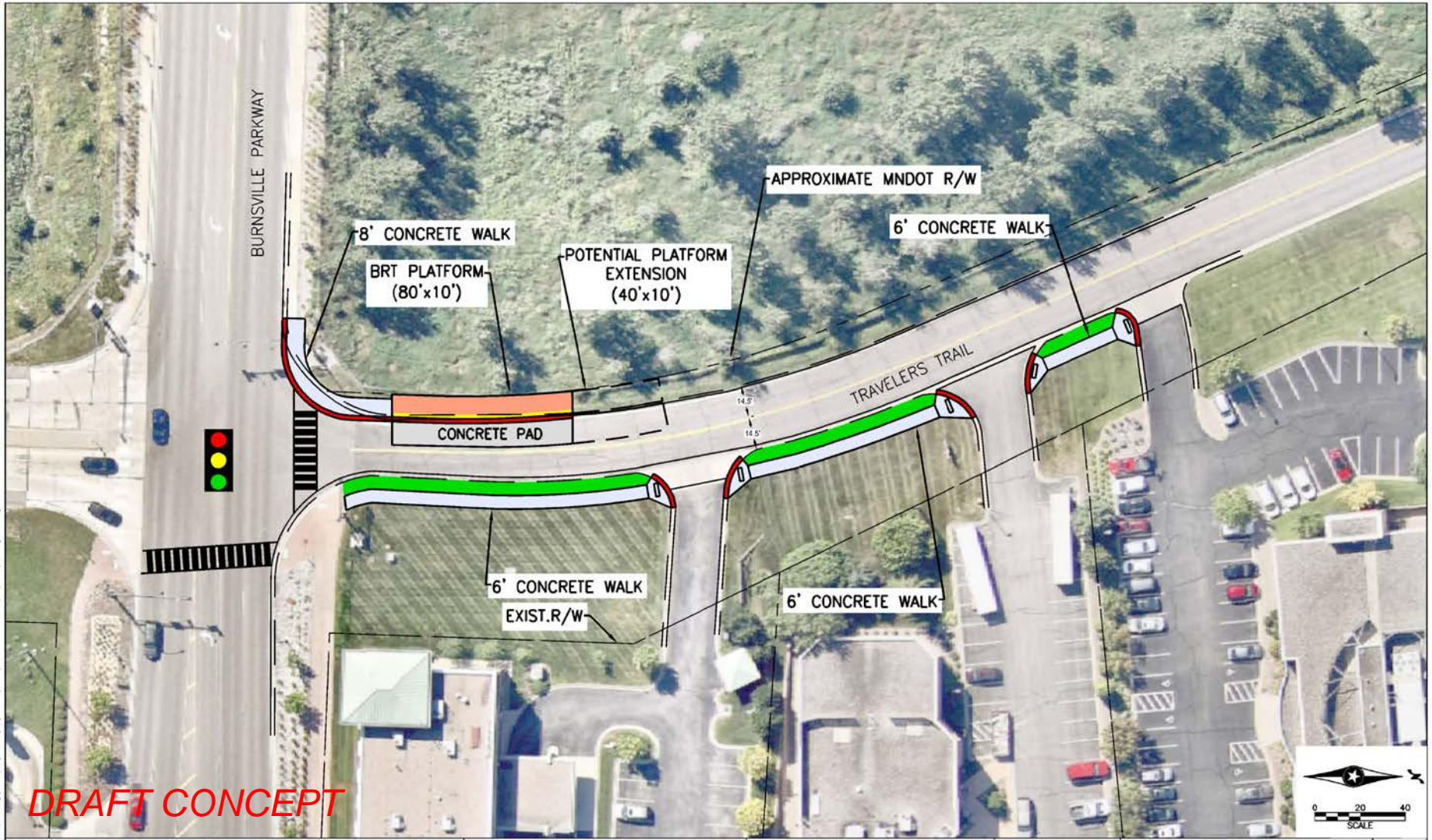

**DRAFT CONCEPT**



# Burnsville – Orange Line Station Connections

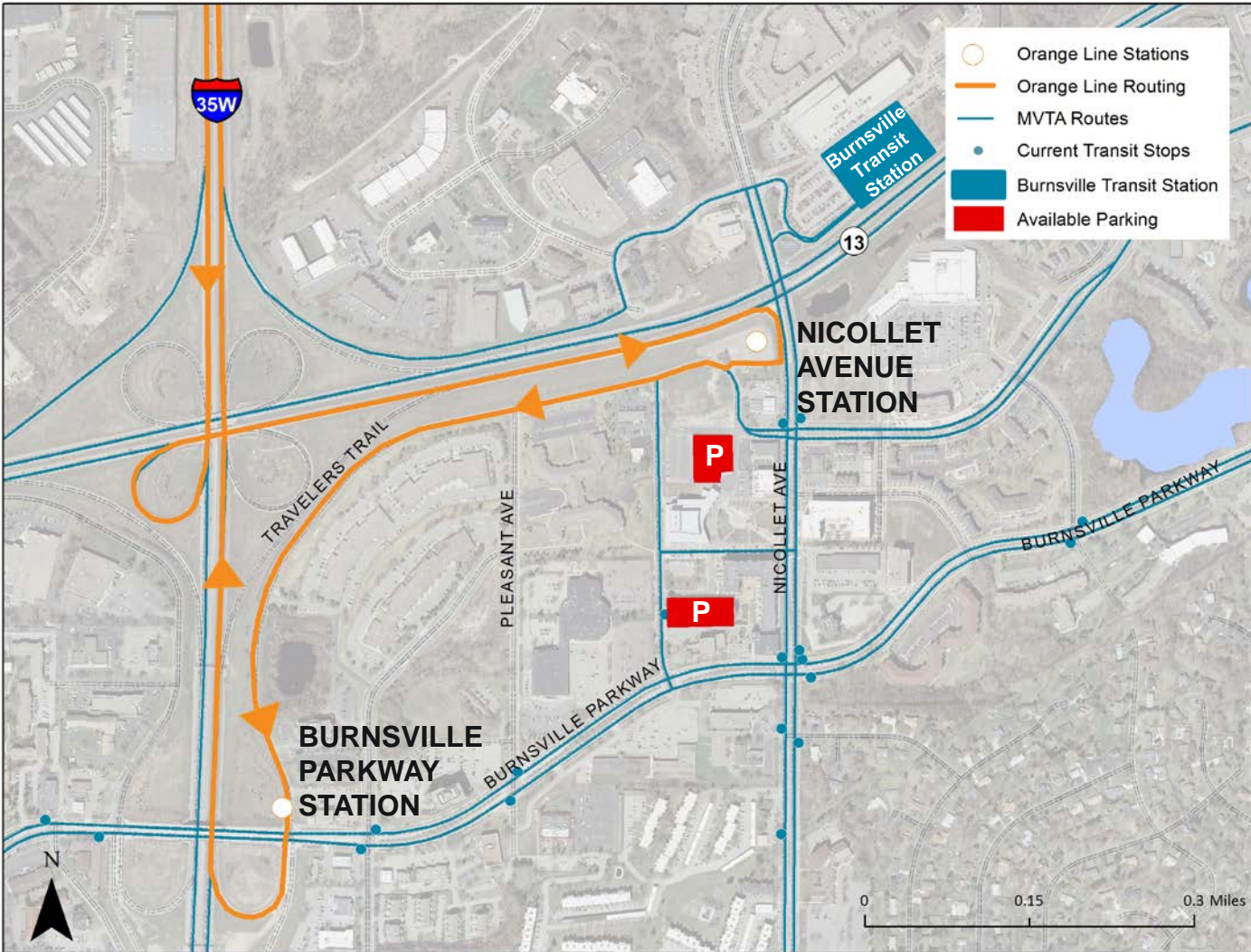

# MVTA Service Connections

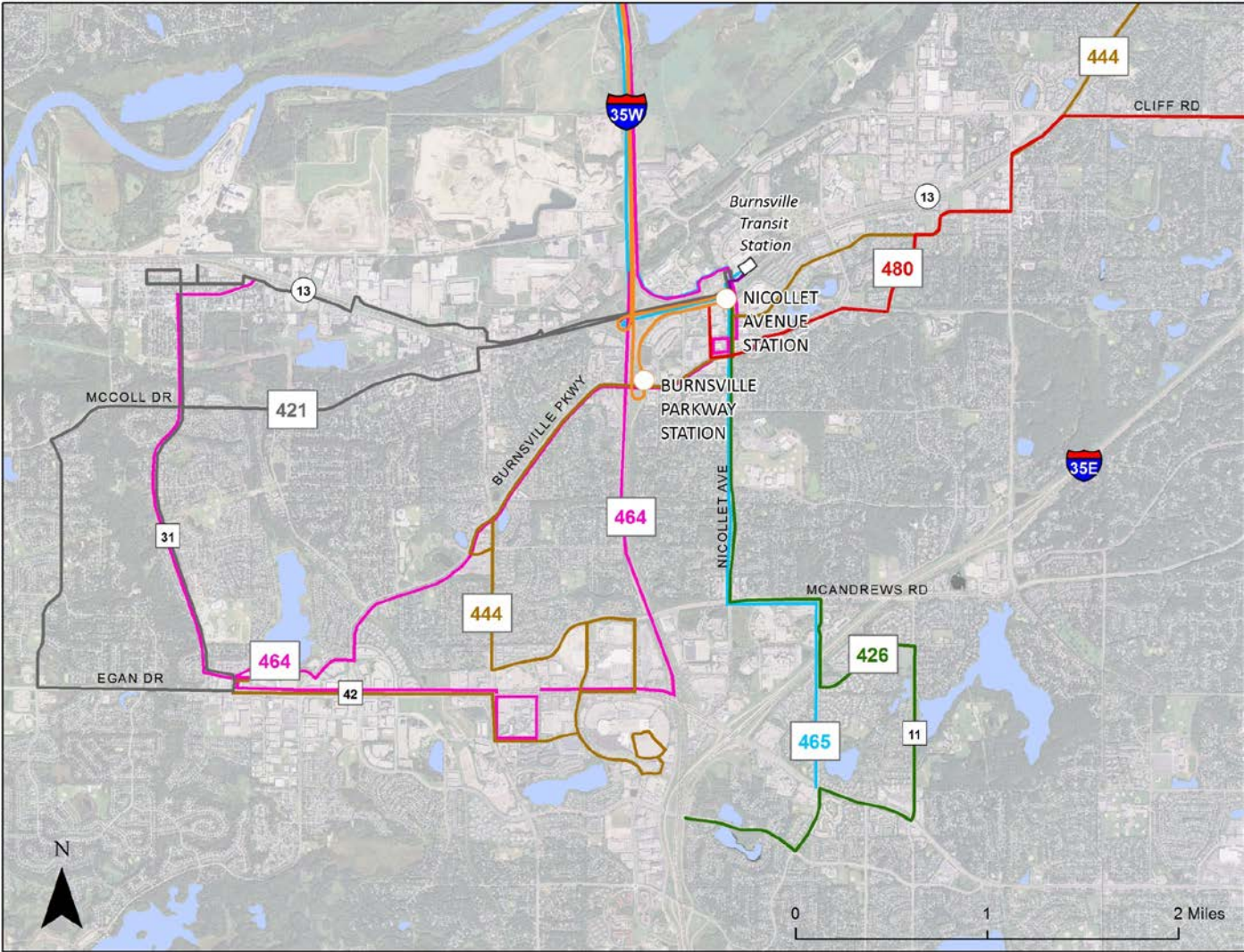



# Public Engagement & Station Design Feedback

- Burnsville Transportation Roundtable: April 27<sup>th</sup>
- Orange Line Environmental Impacts & Benefits Open Houses
  - May 24<sup>th</sup>, Kennedy High School
  - June 15<sup>th</sup>, Burnsville Transit Station
- Orange Line Technical Advisory Committee
- 35W Solutions Alliance
- City of Burnsville
- Heart of the City community engagement

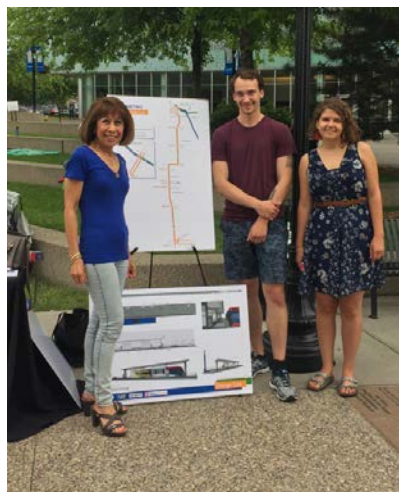



# Public Feedback

- Support for the Nicollet Avenue Station location, south side of Highway 13
  - Closer to Heart of the City destinations
  - Desire to utilize Heart of the City municipal ramp
  - No need to cross Highway 13, MVTA service connections exist south of 13
- Critical need for all-day and weekend service on I-35W
  - Allows for greater flexibility with more options
  - Makes transit a feasible option for automobile owners
  - Brings more benefits to local riders
- Orange Line supports residents' vision for growth and higher density in Heart of the City
- Orange Line is an attractive amenity for prospective residents



Tabling at Friday Fest, Burnsville

# Look Ahead

## June – August

### *Station Area Engagement & Community Involvement*

- Collaborate with City of Burnsville on comprehensive plan engagement
- Focus on underrepresented communities (seniors, school groups, renters)
- Reach out to daily users of Heart of the City including park users, employees, and customers
- Seek DCRRA input on both Burnsville Stations
- Incorporate station design input by late July for 30% plans

**Late Summer Small Starts FTA Submittal** – Requires local and regional funding to succeed

**Fall 2016** – Seek next level design input on station design plans

### *Ongoing - Orange Line Extension*

- Planning
- Regional Solicitation grant application

# Path to collaborative I-35W/Lake Street construction schedule requires funding progress prior to September 2 FTA deadline

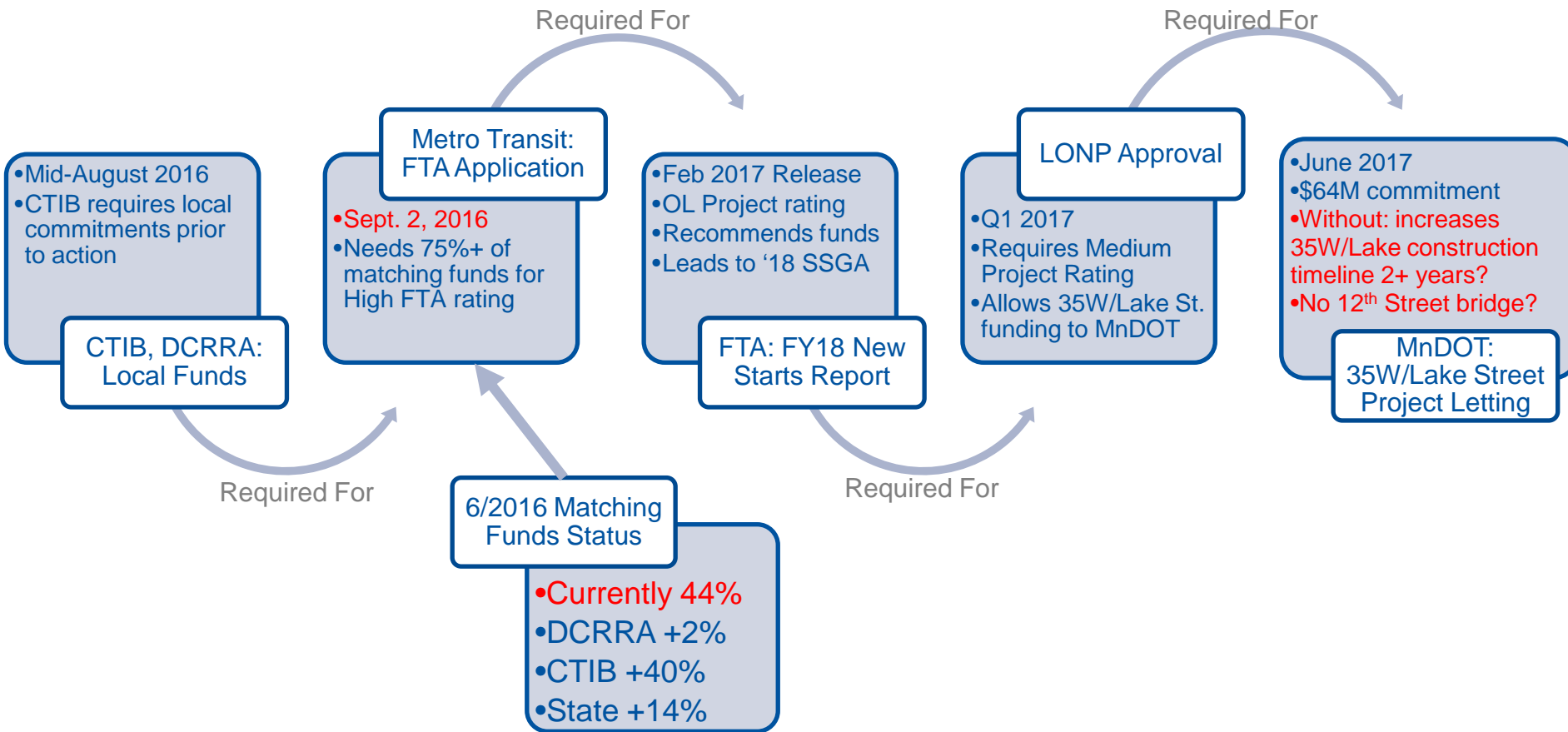



[www.metrotransit.org/orangeline](http://www.metrotransit.org/orangeline)

Charles Carlson, Project Director  
[charles.carlson@metrotransit.org](mailto:charles.carlson@metrotransit.org)  
612-349-7639